

# Parcel Agent 360 Property Report

13 Princeton Rd, Wayne, PA 19087-2651

Tredyffrin Twp

Tax ID 43-11C-0217

## Public Records



## Summary Information

Owner:	C Terrance & Michele V Hawk	Property Class:	Residential
Owner Address:	13 Princeton Rd	Annual Tax:	\$5,685
Owner City State:	Wayne Pa	Record Date:	07/20/99
Owner Zip+4:	19087-2651	Settle Date:	07/12/99
Owner Occupied:	Yes	Sale Amount:	\$275,000
No Mail(P):	Yes	Book:	4602
Owner Carrier Rt:	C011	Page:	246
		Tax Record Updated:	02/13/19

## Geographic Information

County:	Chester, PA	Lot:	0217
Municipality:	Tredyffrin Twp	Grid:	7927D2
High Sch Dist:	Tredyffrin-Easttown	Census:	3001.092
Subdiv/Neighbrhd:	Deepdale		
Tax ID:	43-11C-0217		
Tax Map:	11C		

## Assessment & Tax Information

Tax Year:	2019	Annual Tax (Est):	\$5,685	Total Land Asmt:	\$72,330
County Tax:	\$834	Taxable Land Asmt:	\$72,330	Total Bldg Asmt:	\$118,600
Municipal Tax:	\$463	Taxable Bldg Asmt:	\$118,600	Total Asmt:	\$190,930
School Tax (Est):	\$4,388			Taxable Total Asmt:	\$190,930

## Lot Characteristics

Sq Ft:	18,004	Zoning:	R2
Acres:	0.4133	Traffic:	Light
Roads:	Paved	County Location:	Neighborhood/Spot
Topography:	Level		

## Building Characteristics

Total SQFT:	1,417	Total Rooms:	6	Basement Type:	Full
Residential Type:	Single/Det	Bed Rooms:	3	Garage Type:	Att/BuiltIn/Bsmt
Residential Design:	1 Story	Full Baths:	2	Gas:	Public
Stories:	1.00	Total Baths:	2.0	Water:	Public
Total Units:	1	Family Room:	0	Sewer:	Public
Abv Grd Fin SQFT:	1,417	Exterior:	Brick	Year Built:	1954
Fireplace Total:	1	Residential Style:	Ranch/Ranchette	Trad Fireplace:	1
Attic Type:	None	Fireplace:	Yes	Fireplace Stacks:	1
Cooling:	None	Att Grg SQFT:	480	Heat Fuel:	Oil
		Heat Delivery:	Hot/Warm Air		

## Codes & Descriptions

Land Use: R10 Res: 1 Fam  
 County Legal Desc: LOT & DWG

**MLS History**

MLS Number	Category	Status	Status Date	Price
1000003244	RES	Closed	07/12/99	\$275,000

**Tax History**

Year	Annual Tax Amounts				Annual Assessment					
	County	Municipal	School	Annual	Land	Building	Ttl Taxable	Total Land	Total Bldg	Total Asmt
2019	\$834	\$463	\$4,388	\$5,685	\$72,330	\$118,600	\$190,930	\$72,330	\$118,600	\$190,930
2018	\$834	\$454	\$4,388	\$5,676	\$72,330	\$118,600	\$190,930	\$72,330	\$118,600	\$190,930
2017	\$834	\$454	\$4,284	\$5,573	\$72,330	\$118,600	\$190,930	\$72,330	\$118,600	\$190,930
2016	\$795	\$454	\$4,151	\$5,401	\$72,330	\$118,600	\$190,930	\$72,330	\$118,600	\$190,930
2015	\$795	\$454	\$4,007	\$5,256	\$72,330	\$118,600	\$190,930	\$72,330	\$118,600	\$190,930
2014	\$795	\$454	\$3,860	\$5,109	\$72,330	\$118,600	\$190,930	\$72,330	\$118,600	\$190,930
2013	\$795	\$454	\$3,740	\$4,990	\$72,330	\$118,600	\$190,930	\$72,330	\$118,600	\$190,930
2012	\$757	\$441	\$3,678	\$4,876	\$72,330	\$118,600	\$190,930	\$72,330	\$118,600	\$190,930
2011	\$757	\$426	\$3,560	\$4,743	\$72,330	\$118,600	\$190,930	\$72,330	\$118,600	\$190,930
2010	\$757	\$426	\$3,431	\$4,614	\$72,330	\$118,600	\$190,930	\$72,330	\$118,600	\$190,930
2009	\$757	\$426	\$3,336	\$4,518	\$72,330	\$118,600	\$190,930	\$72,330	\$118,600	\$190,930
2008	\$726	\$416	\$3,240	\$4,383	\$72,330	\$118,600	\$190,930	\$72,330	\$118,600	\$190,930
2007	\$726	\$403	\$3,105	\$4,234	\$72,330	\$118,600	\$190,930	\$72,330	\$118,600	\$190,930
2006	\$706	\$403	\$3,003	\$4,112	\$72,330	\$118,600	\$190,930	\$72,330	\$118,600	\$190,930
2005	\$679	\$403	\$2,889	\$3,971	\$72,330	\$118,600	\$190,930	\$72,330	\$118,600	\$190,930
2004	\$652	\$403	\$2,849	\$3,903	\$72,330	\$118,600	\$190,930	\$72,330	\$118,600	\$190,930
2003	\$625	\$382	\$2,849	\$3,855	\$72,330	\$118,600	\$190,930	\$72,330	\$118,600	\$190,930

**Sale & Mortgage**

Record Date: 07/20/1999      Book: 4602  
 Settle Date: 07/12/1999      Page: 246  
 Sales Amt: \$275,000      Doc Num:  
 Sale Remarks:  
 Owner Names: C Terrance & Michele V Hawk

Mort Rec Date: 07/22/2003      Lender Name: WELLS FARGO HM MTG INC  
 Mort Date: 03/22/2003      Term: 30  
 Mort Amt: \$157,194      Due Date: 07/01/2033  
 Remarks: Conv, Fixed, Refinance

Mort Rec Date: 07/20/1999      Lender Name: NORWEST MTGE INC  
 Mort Date:      Term: 0  
 Mort Amt: \$195,000      Due Date: 08/01/2029  
 Remarks: Conv

Mort Rec Date: 11/20/2001      Lender Name: WELLS FARGO HOME MTGE INC  
 Mort Date:      Term: 30  
 Mort Amt: \$171,000      Due Date: 12/01/2031  
 Remarks: Conv, Refinance

Record Date: 11/01/1986      Book:  
 Settle Date:      Page:  
 Sales Amt: \$135,500      Doc Num:  
 Sale Remarks:  
 Owner Names: Rodger M & Deanne C Halverson

Mort Rec Date: 10/23/1996  
 Mort Date:  
 Mort Amt: \$50,000  
 Remarks: Conv

Lender Name: FIRSTRUST SAV BK  
 Term: 0  
 Due Date:

Mort Rec Date: 02/26/1999  
 Mort Date:  
 Mort Amt: \$200,000  
 Remarks: Conv

Lender Name: FTM MTGE CO  
 Term: 0  
 Due Date: 03/01/2029

**Flood Report**

Flood Zone in X  
 Center of Parcel:  
 Flood Code Desc: Zone X-An area that is determined to be outside the 100- and 500-year floodplains.  
 Flood Zone Panel: 42029C0170G Panel Date: 09/29/2017  
 SFHA Definition: Out Special Flood Hazard Area Out (SFHA):

Within 250 feet of multiple flood zone:

**History**

**13 Princeton Rd, Wayne, PA 19087**

**Tredyffrin Twp - Chester County (10343)**

**Property History**

Source	Category	Status	Date	Price	Owner
Public Records		Settle Date	07/12/1999	\$275,000	C Terrance & Michele V Hawk
Public Records		Record Date	11/01/1986	\$135,500	Rodger M & Deanne C Halverson

**MLS History Details**

Listing Info	Change Type	Effective Date	Price
MLS#: <a href="#">1000003244</a>	Final Closed Price	07/12/99	\$275,000
Prop. Type: Residential	Closed	07/12/99	
DOM / CDOM: 17 / 17	Pending	06/12/99	
Listing Office: <a href="#">BHHS Fox &amp; Roach-Haverford</a>	New Listing	05/27/99	\$279,000

**Maps**

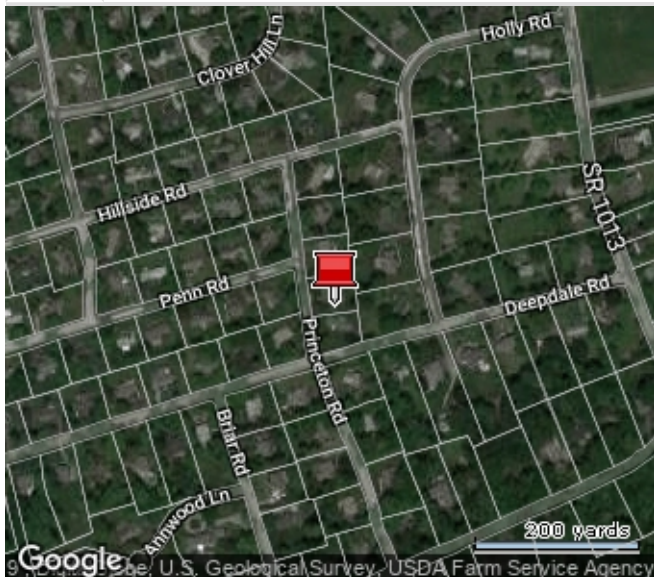

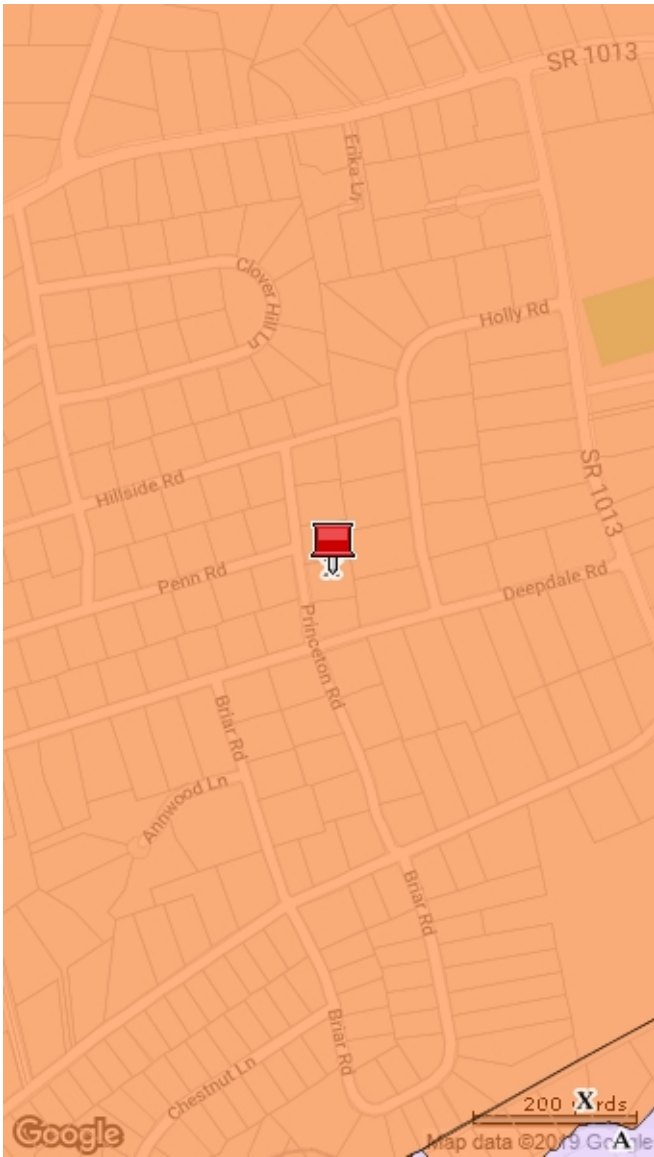

- Coastal 100-Year Floodway
- Coastal 100-year Floodplain
- 100-year Floodway     100-year Floodplain
- Undetermined
- 500-year Floodplain incl. levee protected area
- Out of Special Flood Hazard Area

The data on this report is compiled by BRIGHT from various public and private sources. The data on this is not a legal flood determination. Errors may exist in any field on this report, including owner's name, tax amounts, mortgage history, and property characteristics. Verify the accuracy of all data with the county or municipality.